

# Block 5 - Part V

**NOTE:**  
Do not scale from this drawing, written dimensions only to be used. This drawing is for planning purposes only & not for construction. Levels shown are for information purposes only & may not relate to O.S. Malin Head Datum.  
For actual O.S. Malin Head Datum always refer to the Site Layout Plan.  
DDA Architects Ltd. retain copyright and ownership of this design which is not transferable.

## MATERIALS :

<b>ROOF</b>	SELECTED STANDING SEAM ROOF FINISH/ SEDUM ROOF
<b>WALLS</b>	SELECTED BRICK OR SELF COLOUR RENDERED BLOCK WORK. SELECTED STONE PANEL FINISH SELECTED ZINC COATED ALUMINIUM WALL PANEL.
<b>WINDOWS</b>	SELECTED U-PVC OR TIMBER DOUBLE GLAZED WINDOWS.
<b>FRONT DOOR</b>	SELECTED U-PVC OR TIMBER FINISH DOOR WITH DOUBLE GLAZED VISION PANELS.
<b>RAIN WATER GOODS</b>	U-PVC OR TIMBER FASCIA AND SOFFIT WITH UPVC OR ALUMINIUM POWDER COATED GUTTERS & DOWNPIPES
<b>CANOPY</b>	ALUMINIUM CLAD CANOPY.
<b>COPINGS, WINDOW SURROUNDS &amp; CILLS</b>	CONCRETE CILLS WITH WRAP AROUND D.P.C. AND INSULATION BEHIND.

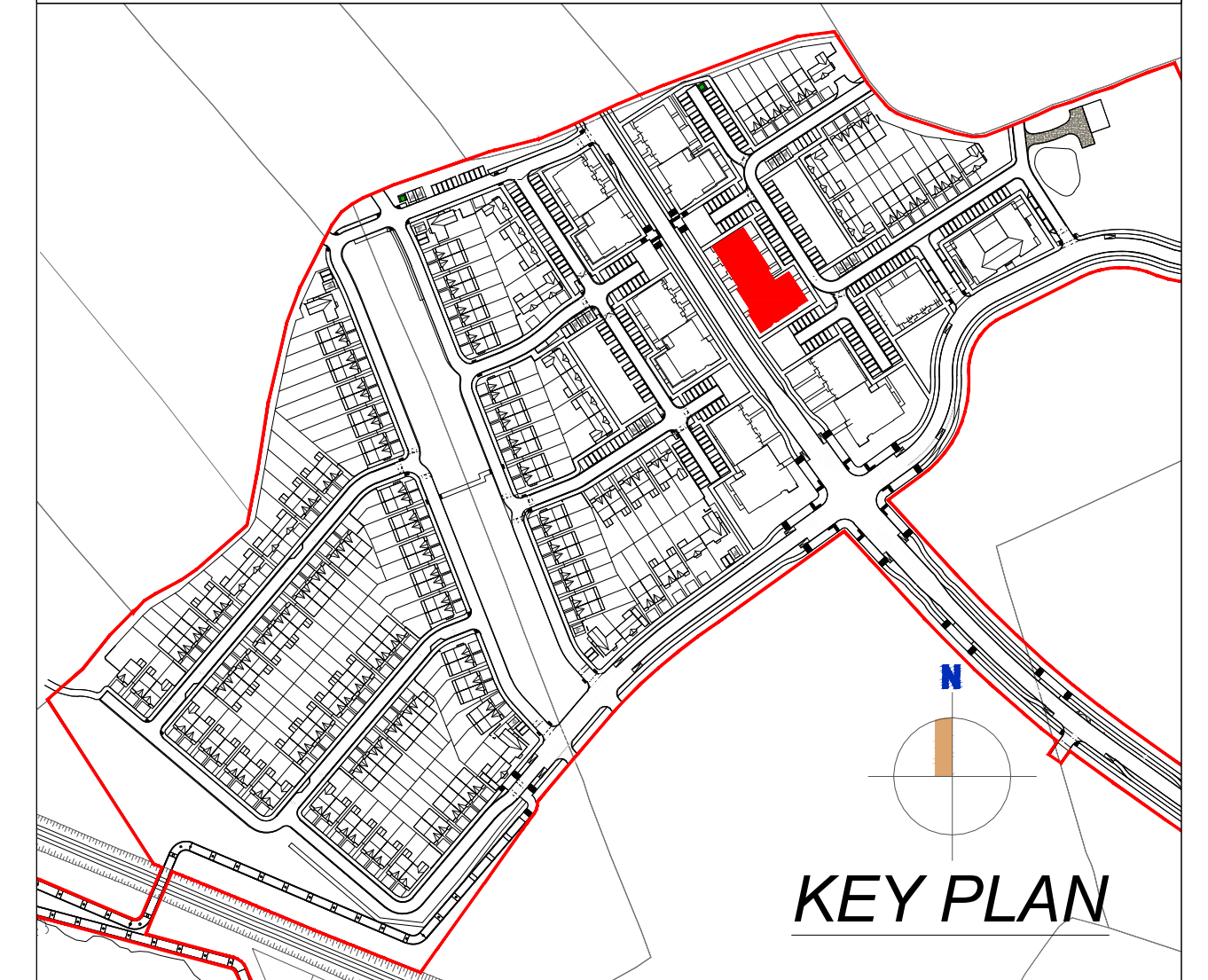

## UNITS ALLOCATED FOR PART V

- 2 BED APT
- 1 BED APT
- 3 BED DUPLEX

REV	DATE	BY	CHKD	DRWN

**DDA DUIGNAN DOOLEY**  
ARCHITECTS AND PLANNING CONSULTANTS  
62 BRIGHTON SQUARE, DUBLIN 6

TEL : 00 353 (1) 490 0499  
EMAIL : info@ddaearch.ie  
WEB : www.ddaearch.ie

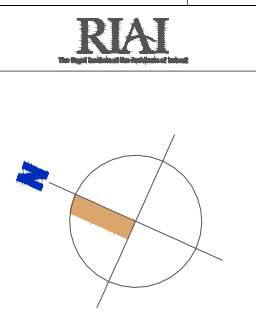

THIS DRAWING IS COPYRIGHT © FIGURED DIMENSIONS ONLY TO BE USED		STATUS: <b>PLANNING</b>	CRD: PD
CLIENT: SHANNON HOMES DROGHEDA LTD	PROJECT TITLE: COLP WEST SHD DROGHEDA	DRAWING NUMBER: 19-001-P-6.502	REV: -
DRAWING TITLE: <b>BLOCK 5 - PART V SECOND FLOOR PLAN</b>	DRAWN: MA	DATE: July 2020	SCALE: 1:100@A1; 1:200@A3