

- NOTES:
- GENERAL NOTES:
1. ALL WORKS SHALL BE CONSTRUCTED IN ACCORDANCE WITH THE NRA SPECIFICATION FOR ROAD WORKS.
 2. ALL DIMENSIONS IN METRES UNLESS SPECIFIED OTHERWISE.
 3. ALL CO-ORDINATES ARE TO IRISH TRANSVERSE MERCATOR (TM).
 4. ALL LEVELS ARE TO ORDNANCE DATUM AND ARE IN METRES.
 5. ALL TEMPORARY TRAFFIC & OPERATIONS MANAGEMENT SHALL COMPLY FULLY WITH THE NRA SPECIFICATION FOR ROAD WORKS.
 6. THE CONTRACTOR MUST LAISE DIRECTLY WITH MEATH COUNTY COUNCIL AS REQUIRED.
 7. ALL VEHICULAR & OPERATIONAL ROUTES WITHIN AND SURROUNDING THE WORKS EXTENTS MUST BE MAINTAINED THROUGHOUT THE WORKS IN ACCORDANCE WITH THE CONTRACTORS APPROVED TEMPORARY TRAFFIC & OPERATIONS MANAGEMENT PLAN AND SHALL COMPLY FULLY WITH THE PROVISIONS OF CH.8 OF THE TRAFFIC SIGNS MANUAL.
 8. CONTRACTOR SHALL EMPLOY THE SERVICES OF AN APPROVED SURVEY COMPANY TO ESTABLISH THE GRID IDENTIFIED IN THE PROVISIONS OF CH.8 OF THE TRAFFIC SIGNS MANUAL.
 9. ALL AGGREGATES PROPOSED FOR USE ON THIS SCHEME SHALL MEET FULLY THE REQUIREMENTS OF THE NRA SPECIFICATION FOR ROAD WORKS AND IN ADDITION THE REQUIREMENTS STATED IN STANDARD RECOMMENDATION S.R. 21:2014 GUIDANCE ON THE USE OF I.S. EN 12620:2002 +A1:2007 - AGGREGATES FOR UNBOUND AND HYDRAULICALLY BOUND MATERIALS FOR USE IN CIVIL ENGINEERING WORK AND ROAD CONSTRUCTION.
- DRAWING SPECIFIC NOTES:
1. REFER TO DRGS 170092-2000 TO 2004 FOR HORIZONTAL ALIGNMENT INFORMATION.
 2. REFER TO DRG 170092-2011 FOR TYPICAL CROSS SECTIONAL CONSTRUCTION DETAILS.

- KEY
- EXISTING GROUND PROFILE
 - PROPOSED GROUND PROFILE STRAIGHT
 - PROPOSED GROUND PROFILE CURVE

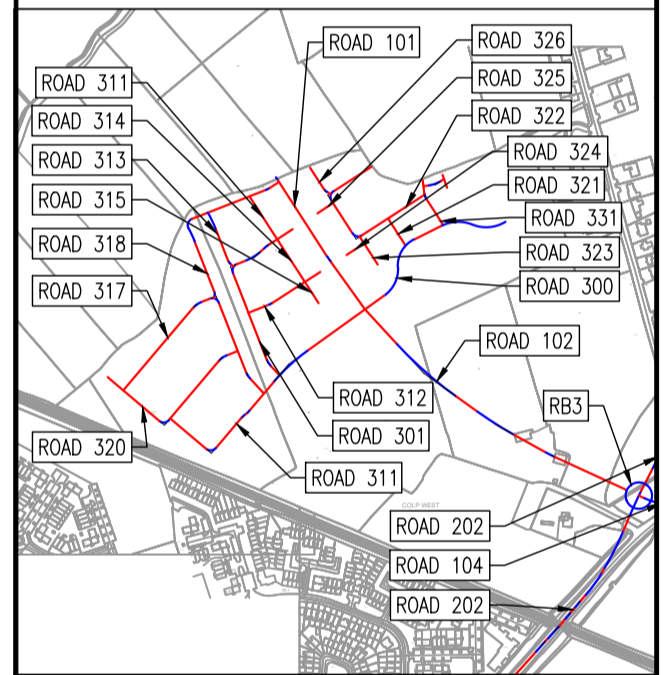

KEYPLAN

B	31-07-20	STAGE 3 NEW APPLICATION	DJG	DMW
A	10-05-20	STAGE 2 NEW APPLICATION	DJG	AGS
REV	DATE	DESCRIPTION	BY	CHKD
PLANNING SHD STAGE 3				
DESIGNED	DMW	PREPARED	DJG	
DATE	OCT 2019	CHECKED	DJR	

DBFL Consulting Engineers
 Dublin Office: Ormond House, Upper Ormond Quay, Dublin 7, Ireland. PHONE +353 1 400 4000 FAX +353 1 400 4050
 Waterford Office: Unit 2, The Chandlery, 1-2 O'Connell Street, Waterford, Ireland. PHONE +353 51 308 500 FAX +353 51 844 913

PROJECT
STRATEGIC HOUSING DEVELOPMENT AT COLPE WEST, DROGHEDA, CO. MEATH

DRG. TITLE
LONGITUDINAL SECTIONS THROUGH ROAD SHEET 2

CLIENT
SHANNON HOMES DROGHEDA LTD.

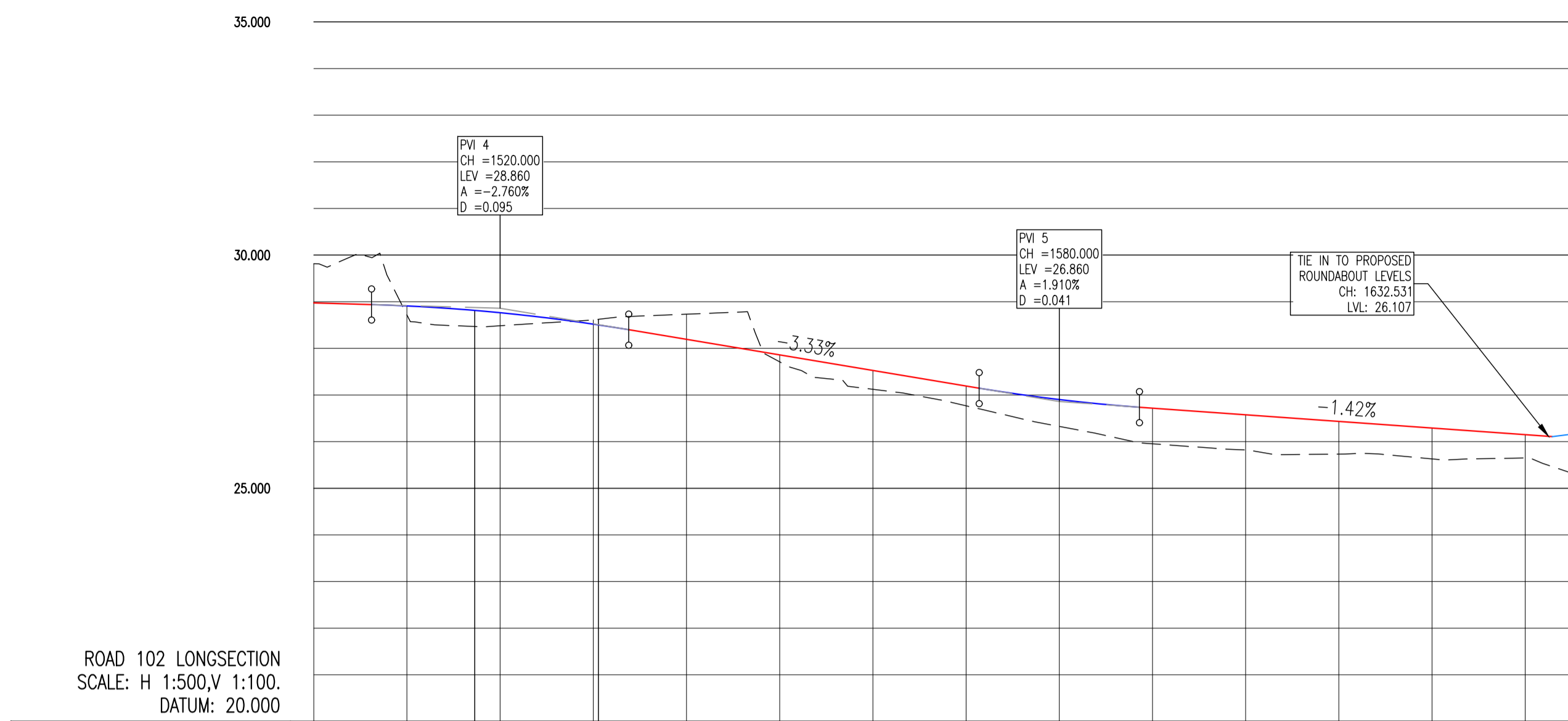

CHAINAGE	1500.000	1510.000	1520.000	1530.000	1540.000	1550.000	1560.000	1570.000	1580.000	1590.000	1600.000	1610.000	1620.000	1630.000	1638.373
EXISTING GROUND LEVELS	28.915	28.716	28.484	28.611	28.732	27.711	27.122	26.788	26.326	25.953	25.822	25.732	25.630	25.649	25.298
PROPOSED LEVELS	28.975	28.910	28.765	28.519	28.193	27.860	27.527	27.193	26.901	26.718	26.575	26.433	26.291	26.149	
VERTICAL GEOMETRY	<p>G = -0.573% L = 1.374</p> <p>R = 1000.000 K = 10.000 L = 27.598</p> <p>G = -3.333% L = 1.30</p> <p>R = 900.000 K = 9.000 L = 17.194</p> <p>G = -1.423% L = 1.70</p>														
HORIZONTAL GEOMETRY	<p>L = 47.459</p> <p>R = 178.000 L = 13.263</p> <p>L = 104.830</p>														

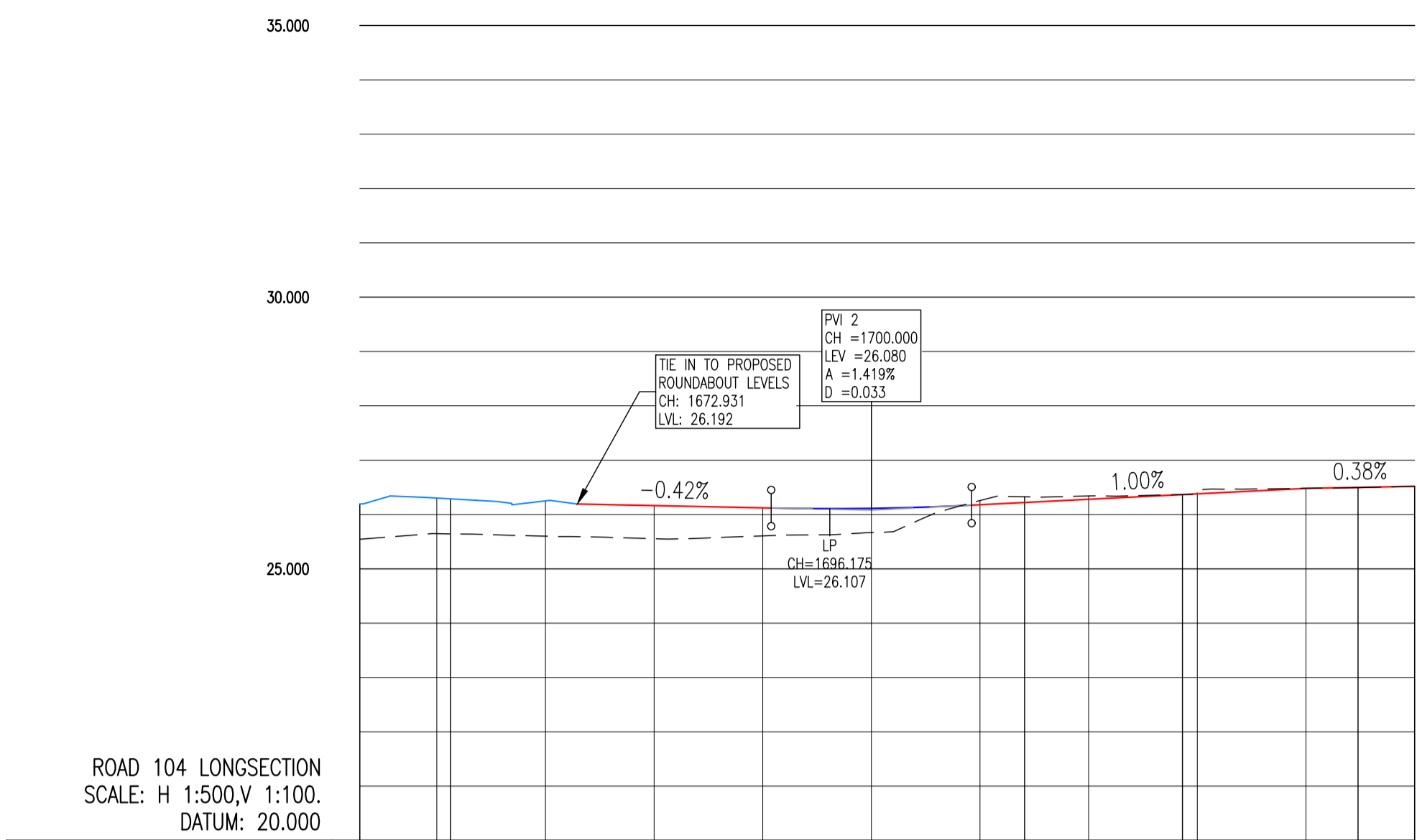

CHAINAGE	1652.912	1660.000	1670.000	1680.000	1690.000	1700.000	1710.000	1720.000	1730.000	1740.000	1750.000
EXISTING GROUND LEVELS	25.546	25.647	25.600	25.555	25.607	25.667	26.257	26.341	26.400	26.482	26.519
PROPOSED LEVELS				26.163	26.122	26.113	26.180	26.281	26.381	26.482	26.519
VERTICAL GEOMETRY	<p>G = -0.42%</p> <p>R = 1300.000 K = 13.000 L = 18.449</p> <p>G = 1.004% L = 1.100</p> <p>G = 0.376% L = 1.264</p>										
HORIZONTAL GEOMETRY	<p>L = 8.347</p> <p>R = 75.000 L = 52.845</p> <p>L = 14.524</p> <p>L = 16.171</p> <p>L = 5.201</p>										

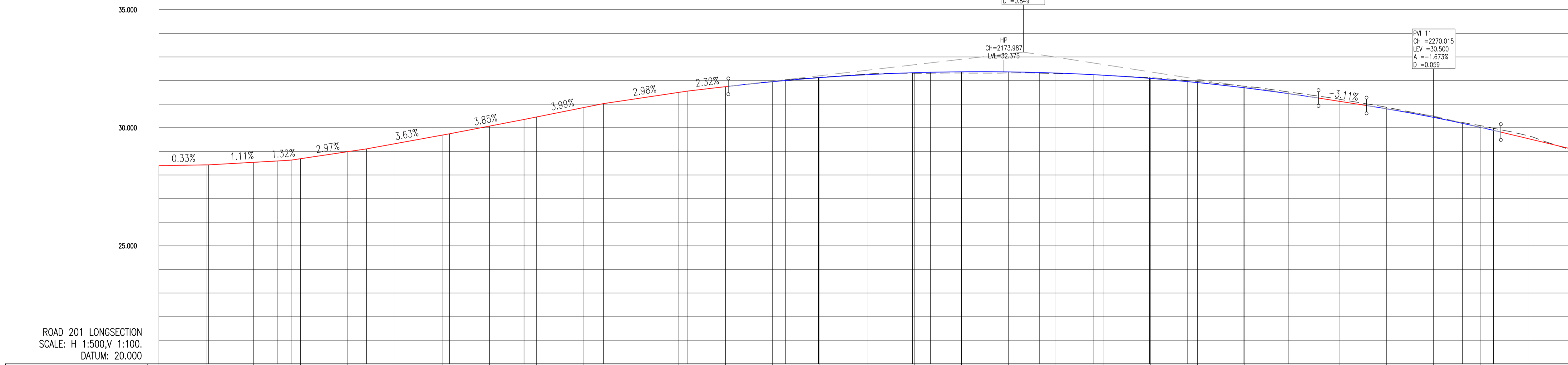

CHAINAGE	2000.000	2010.000	2020.000	2030.000	2040.000	2050.000	2060.000	2070.000	2080.000	2090.000	2100.000	2110.000	2120.000	2130.000	2140.000	2150.000	2160.000	2170.000	2180.000	2190.000	2200.000	2210.000	2220.000	2230.000	2240.000	2250.000	2260.000	2270.000	2280.000	2290.000	2300.000		
EXISTING GROUND LEVELS	28.396	28.429	28.537	28.691	28.989	29.326	29.689	30.070	30.459	30.858	31.198	31.496	31.742	31.955	32.124	32.250	32.376	32.311	32.118	32.021	32.300	32.228	32.093	31.915	31.693	31.478	31.214	30.870	30.441	30.017	29.543	29.024	
PROPOSED LEVELS	28.396	28.429	28.537	28.691	28.989	29.326	29.689	30.070	30.459	30.858	31.198	31.496	31.742	31.955	32.124	32.250	32.376	32.311	32.118	32.021	32.300	32.228	32.093	31.915	31.693	31.478	31.214	30.870	30.441	30.017	29.543	29.024	
VERTICAL GEOMETRY	<p>G = 0.332% L = 1.501</p> <p>G = 1.111% L = 1.90</p> <p>G = 1.616% L = 1.76</p> <p>G = 2.923% L = 1.34</p> <p>G = 3.632% L = 1.28</p> <p>G = 3.848% L = 1.26</p> <p>G = 3.989% L = 1.25</p> <p>G = 2.984% L = 1.34</p> <p>G = 2.321% L = 1.43</p> <p>R = 2300.000 K = 23.000 L = 125.005</p> <p>G = -3.114% L = 1.32</p> <p>R = 1700.000 K = 17.000 L = 28.443</p> <p>G = -4.788% L = 1.21</p>																																
HORIZONTAL GEOMETRY	<p>L = 10.458</p> <p>L = 14.583</p> <p>L = 2.952</p> <p>L = 15.945</p> <p>L = 17.624</p> <p>L = 15.774</p> <p>L = 16.796</p> <p>L = 17.898</p> <p>L = 20.641</p> <p>L = 7.040</p> <p>R = 510.000 L = 19.921</p> <p>L = 3.782</p> <p>R = 510.000 L = 23.151</p> <p>L = 11.329</p> <p>R = 510.000 L = 11.922</p> <p>L = 8.107</p> <p>R = 510.000 L = 11.874</p> <p>L = 9.529</p> <p>R = 210.000 L = 36.829</p> <p>L = 6.524</p> <p>R = 400.000 L = 55.683</p>																																