

- NOTES:
1. ALL WORKS SHALL BE CONSTRUCTED IN ACCORDANCE WITH THE NRA SPECIFICATION FOR ROAD WORKS.
  2. ALL DIMENSIONS IN METRES UNLESS SPECIFIED OTHERWISE.
  3. ALL CO-ORDINATES ARE TO IRISH TRANSVERSE MERCATOR (TM).
  4. ALL LEVELS ARE TO ORDNANCE DATUM AND ARE IN METRES.
  5. ALL TEMPORARY TRAFFIC & OPERATIONS MANAGEMENT SHALL COMPLY FULLY WITH THE NRA SPECIFICATION FOR ROAD WORKS.
  6. THE CONTRACTOR MUST LIAISE DIRECTLY WITH MEATH COUNTY COUNCIL AS REQUIRED.
  7. ALL VEHICULAR & OPERATIONAL ROUTES WITHIN AND SURROUNDING THE WORKS EXTENTS MUST BE MAINTAINED THROUGHOUT THE WORKS IN ACCORDANCE WITH THE CONTRACTORS APPROVED TEMPORARY TRAFFIC & OPERATIONS MANAGEMENT PLAN AND SHALL COMPLY FULLY WITH THE PROVISIONS OF CH.8 OF THE TRAFFIC SIGNS MANUAL.
  8. CONTRACTOR SHALL EMPLOY THE SERVICES OF AN APPROVED SURVEY COMPANY TO ESTABLISH THE GRID IDENTIFIED IN THE MANAGEMENT PLAN AND SHALL COMPLY FULLY WITH THE PROVISIONS OF CH.8 OF THE TRAFFIC SIGNS MANUAL.
  9. ALL AGGREGATES PROPOSED FOR USE ON THIS SCHEME SHALL MEET FULLY THE REQUIREMENTS OF THE NRA SPECIFICATION FOR ROAD WORKS AND IN ADDITION THE REQUIREMENTS STATED IN STANDARD RECOMMENDATION S.R. 21:2014 GUIDANCE ON THE USE OF U.S. EN 13242-2002 +A1:2007 - AGGREGATES FOR UNBOUND AND HYDRAULICALLY BOUND MATERIALS FOR USE IN CIVIL ENGINEERING WORK AND ROAD CONSTRUCTION.
- DRAWING SPECIFIC NOTES:
1. REFER TO DRGS 170092-2000 TO 2004 FOR HORIZONTAL ALIGNMENT INFORMATION.
  2. REFER TO DRG 170092-2011 FOR TYPICAL CROSS SECTIONAL CONSTRUCTION DETAILS.

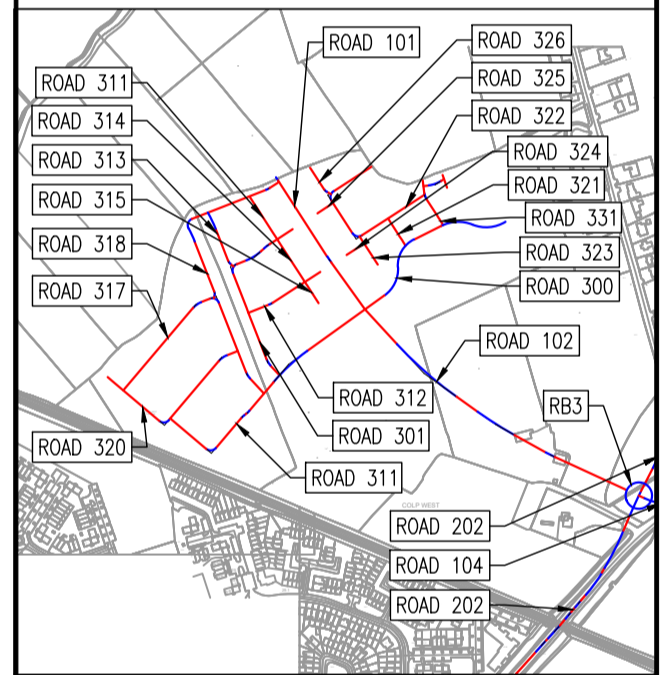
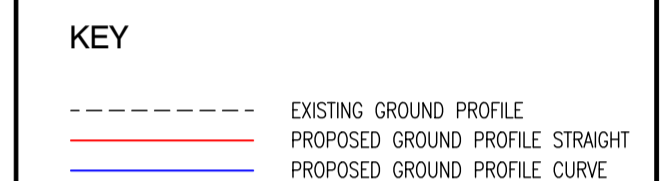

KEYPLAN

B	31-07-20	STAGE 3 NEW APPLICATION	DJG	DMW
A	10-05-20	STAGE 2 NEW APPLICATION	DJG	AGS
REV.	DATE	DESCRIPTION	BY	CHKD.
<b>PLANNING SHD STAGE 3</b>				
DESIGNED	DMW	PREPARED	DJG	
DATE	OCT 2019	CHECKED	DJR	

DBFL Consulting Engineers email: info@dbfl.ie site: www.dbfl.ie

WATERFORD OFFICE Unit 2, The Chandley, 1-2 O'Connell Street, Waterford, Ireland. PHONE: +353 51 338 500 FAX: +353 51 844 813

PROJECT  
**STRATEGIC HOUSING DEVELOPMENT AT COLPE WEST, DROGHEDA, CO. MEATH**

DRG. TITLE  
**LONGITUDINAL SECTIONS THROUGH ROAD SHEET 4**

CLIENT  
**SHANNON HOMES DROGHEDA LTD.**

SCALE AS SHOWN @A1 FILE REF. 170092-2071  
DRG. NO. **170092-2074** **B**

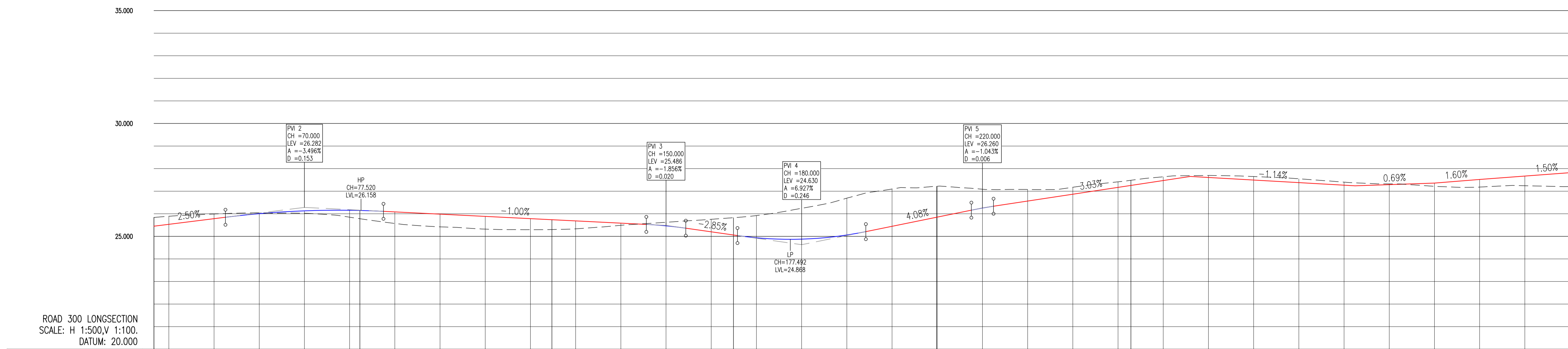

CHAINAGE	36.898	40.000	50.000	60.000	70.000	80.000	90.000	100.000	110.000	120.000	130.000	140.000	150.000	160.000	170.000	180.000	190.000	200.000	210.000	220.000	230.000	240.000	250.000	260.000	270.000	280.000	290.000	300.000	310.000	320.000	330.000	340.000	350.000
EXISTING GROUND LEVELS	25.537	25.890	25.991	26.041	26.024	25.849	25.570	25.421	25.321	25.295	25.332	25.490	25.623	25.755	25.919	26.244	26.692	27.096	27.220	27.087	27.076	27.174	27.415	27.639	27.609	27.650	27.550	27.402	27.324	27.217	27.183	27.142	27.207
PROPOSED LEVELS	25.450	25.532	25.762	26.004	26.130	26.155	26.083	25.984	25.884	25.784	25.685	25.585	25.465	25.200	24.937	24.876	25.059	25.445	25.853	26.254	26.563	26.866	27.170	27.473	27.609	27.495	27.381	27.266	27.291	27.360	27.500	27.670	27.820
VERTICAL GEOMETRY	G = 2.500% 1.40		R = 1000.000 K = 10.000 L = 34.961				G = -0.996% -1.100		R = 470.000 K = 4.700 L = 8.722		G = -2.852% -1.35		R = 410.000 K = 4.100 L = 28.400		G = 4.075% 1.25		R = 470.000 K = 4.700 L = 4.901		G = 3.032% 1.33		G = -1.141% -1.88		G = 0.692% 1.145		G = 1.600% 1.63		G = 1.500% 1.67						
HORIZONTAL GEOMETRY	R = 48.508 L = 45.358				R = 49.620 L = 42.499				L = 40.158				R = 38.750 L = 44.942				R = 43.000 L = 42.984				L = 125.546												

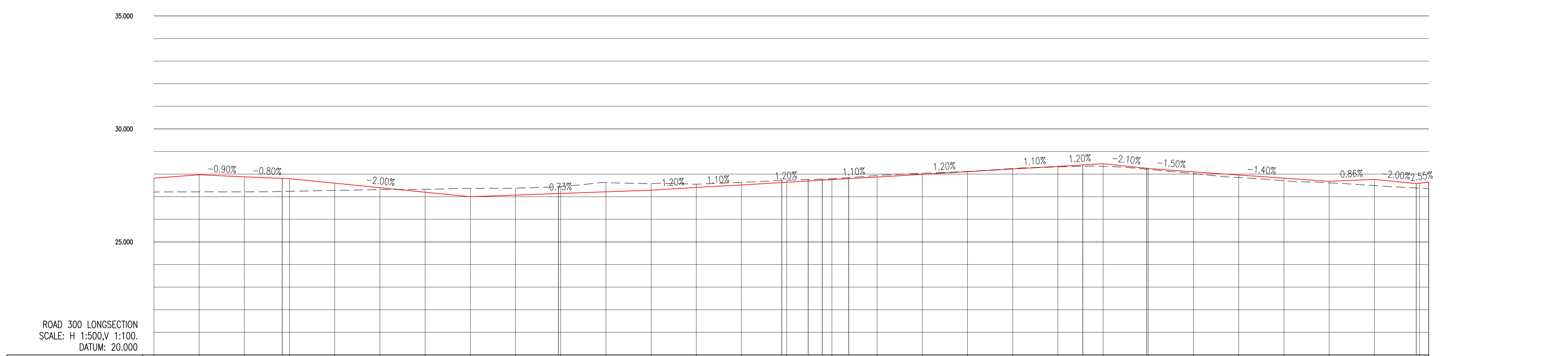

CHAINAGE	350.000	360.000	370.000	380.000	390.000	400.000	410.000	420.000	430.000	440.000	450.000	460.000	470.000	480.000	490.000	500.000	510.000	520.000	530.000	540.000	550.000	560.000	570.000	580.000	590.000	600.000	610.000	620.000	630.000	632.027				
EXISTING GROUND LEVELS	27.507	27.215	27.216	27.238	27.280	27.311	27.331	27.385	27.380	27.451	27.630	27.585	27.553	27.638	27.730	27.791	27.839	28.035	28.116	28.245	28.320	28.346	28.209	28.024	27.850	27.708	27.613	27.493	27.376	27.352				
PROPOSED LEVELS	27.280	27.197	27.280	27.800	27.600	27.400	27.200	27.000	27.072	27.145	27.217	27.290	27.410	27.520	27.640	27.760	27.870	27.990	28.110	28.230	28.340	28.460	28.250	28.100	27.960	27.820	27.680	27.766	27.598	27.650				
VERTICAL GEOMETRY	G = 1.500% 1.67		G = -0.900% -1.111		G = -0.800% -1.125		G = -2.000% -1.138				G = 1.200% 1.83		G = 1.100% 1.91		G = 1.200% 1.83		G = 1.100% 1.91		G = 1.200% 1.83		G = 2.100% -1.78		G = -1.500% -1.67		G = -1.400% -1.71		G = 0.855% 1.117		G = -2.000% -1.50		G = 2.55% 1.739			
HORIZONTAL GEOMETRY	L = 125.546				R = 250.000 L = 61.110				L = 49.414				R = 26.000 L = 5.640				R = 26.000 L = 5.640				L = 51.814				R = 9.000 L = 14.137				L = 59.623				L = 2.750	